



2012-2017

Student

Bataan Peninsula State University (BPSU) is a higher education institution in the Philippines that offers a variety of programs and services. Have multiple campuses and are dedicated to providing excellent education and contributing to national and regional development. The university also makes education more accessible to the community by offering extension programs in nearby towns and working with local and international partners to support its efforts and goals.



Business Process Outsourcing (BPO) Tower

The proposed Business Process Outsourcing (BPO) tower in the Philippines aims to capitalize on the country's rapidly growing BPO industry, which is expected to surpass remittances from overseas Filipino workers in 2017. This commercial and office building will create job opportunities for Filipinos in various outsourcing fields such as call centers, animation, software and game development, and engineering design. The design of the building will feature a commercial retail podium that will provide additional revenue and convenience for employees and visitors, while the upper floors will house office spaces designed to accommodate the specific needs of BPO companies.

As a fourth-year college student working on a solo major plate project for a proposed Business Process Outsourcing (BPO) tower in the Philippines, it is crucial to provide a comprehensive design and plan that effectively communicates the concept and functionality of the building. Providing site development plan, floor plans, elevations, sections, renderings, details, concept etc.

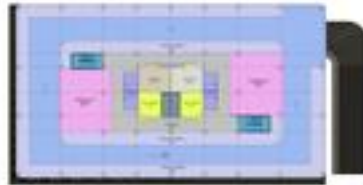
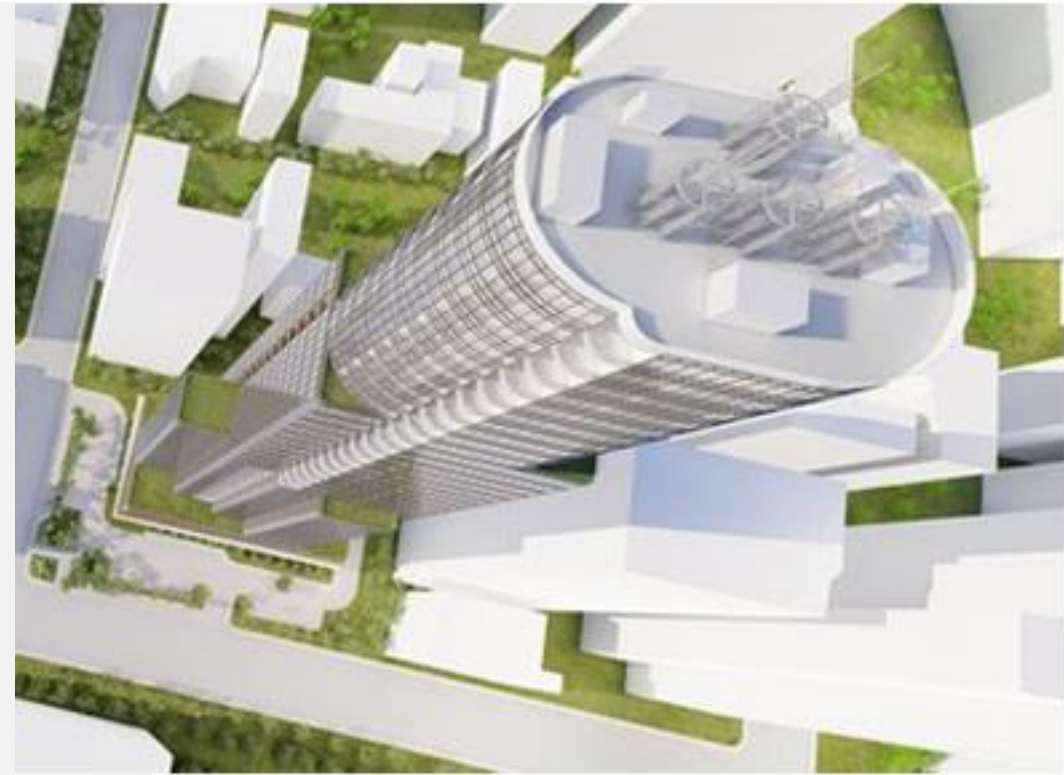



Modular Pasig River Ferry Terminal

To address the transportation challenges in Metro Manila, one effective solution is to promote the use of public transportation over private vehicles. By providing infrastructure and facilities that encourage the use of waterways, it can help decrease traffic congestion and reduce the number of cars on the road. The Pasig River plays a crucial role in this regard, as its utilization as a mode of transportation can greatly contribute to a more sustainable transportation system. A modular Pasig River Ferry Terminal can be an essential component in achieving this goal, as it would provide the necessary facilities to make commuting by water a viable and attractive option for commuters.



As a fourth-year college student working on a solo major plate project for a proposed Modular Pasig River Ferry Terminal, it is crucial to provide a comprehensive design and plan that effectively communicates the concept and functionality of the building. Providing site development plan, floor plans, elevations, sections, renderings, details, concept etc.





2017-2019

Junior Architect

Andrade Builders is a reputable construction company that provides a wide range of services, including new home construction, office and residential renovation, and fit-outs. Have a team of highly skilled and experienced professionals, including architects, engineers, and construction experts, who have the expertise and knowledge to handle projects of any size and complexity.



Two Storey Condominium Unit interior fit-out

The project described is a fit-out of a two-storey high-end condominium unit, to be designed and constructed by Andrade Builders. The client, a Korean national, has expressed an interest in Asian architecture, and this has been incorporated into the design of the interior. The design will feature a harmonious blend of neutral colors for wall paints and incorporate geometric patterns as striking wall accents. Additionally, the project will adhere to the principle of sustainability by recycling on-site existing materials that can still be used.

As the site manager, my responsibilities are preparing detailed technical drawings, updating the architectural layout of engineering systems, managing construction efforts including materials, manpower and quality control, preparing contract documents, specifications, cost estimates and other administrative tasks, and finally preparing as-built plans and obtaining necessary permits. It is crucial to maintain clear communication with all stakeholders, ensure that all requirements are met and keep the project well-organized and well-documented throughout the process, including keeping track of design development and final presentations.



Office interior fit-out

The project described is an office interior fit-out for a cleaning services company, designed and constructed by Andrade Builders. The design features an industrial-style architecture, which presents a unique challenge in creating an atypical and visually pleasing. The project also makes use of the natural beauty of materials, incorporating them into the design of furniture, wall cladding, and systems. The walls will be painted to emulate a concrete finish.

As the project in charge of construction, my responsibilities are creating detailed architectural drafting, preparing technical drawings, developing architectural layouts of engineering systems, managing construction efforts, including materials, manpower and quality control, preparing contract documents, specifications, cost estimates, and other administrative tasks. It is crucial to maintain clear communication with all stakeholders, ensure that all requirements are met, and keep the project well-organized and well-documented throughout the process, including keeping track of design development and final presentations.





Two storey residence

The project described is a two-storey high-end residential building designed by DDC Arch studio and constructed by Andrade Builders. The complex shape structure was meticulously crafted for a British client, achieved through the manipulation of concrete material. The exterior will showcase the use of unusual paint materials to achieve the best results, with a focus on clean fine lines and straight edges. Sustainability is at the core of the project, with the integration of solar panels to harness the power of the sun. The design also incorporates the integration of technology such as automated gates, and other smart home features to provide the residents with a comfortable and convenient living experience.

As the project in charge of construction, my responsibilities include creating detailed technical drawings, managing construction efforts, including materials, manpower, and quality control, preparing contract documents, cost estimates and other administrative tasks, and finally preparing as-built plans and obtaining necessary permits. It is crucial to maintain clear communication with all stakeholders, ensure that all requirements are met, and keep the project well-organized and well-documented throughout the process, including keeping track of design development and final presentations.





Three storey educational building

The project described is a three-storey educational building, designed and constructed by Andrade Builders, using the Brutalism architecture style for a privately-owned school. The design features playful colors and geometric shapes on balustrades around the open areas below, using perforated blocks or wall screens. The colors used are carefully chosen to create a comfortable and conducive learning environment for students, and to enhance focus during lessons. The professionals have also ensured that the structure is safe, even in high-water table areas, through proper structural design and construction methods.

As the project in charge of construction, my responsibilities are include creating detailed technical drawings, managing construction efforts, including materials, manpower, and quality control, preparing contract documents, specifications, cost estimates and other administrative tasks. Additionally, it is crucial to maintain clear communication with all stakeholders, ensure that all requirements are met, and keep the project well-organized and well-documented throughout the process, including keeping track of design development, construction progress and final presentations. This will help to ensure that the project meets or exceed the client's expectations and meets the highest standards of safety and quality.



Two storey residence

The project described is a two-storey residence building, designed and constructed by Andrade Builders, inspired by Asian architecture. The Japanese client's desire for intricate details in design makes this project particularly exciting. The design incorporates earthy tones such as white, brown, and red, and makes extensive use of wood in most of the built-in furniture, creating a warm and natural ambiance. Additionally, the design includes the integration of advanced technology for security, such as burglar alarms and closed-circuit television to ensure the safety and peace of mind of the residents.

As the project in charge of construction, my responsibilities include conducting regular meetings with the client, creating detailed technical drawings, developing architectural layouts of engineering systems, managing construction efforts, including materials, manpower, and quality control, preparing contract documents, specifications, cost estimates, and other administrative tasks. It is crucial to maintain clear communication with all stakeholders, ensure that all requirements are met, and keep the project well-organized and well-documented throughout the process, including keeping track of design development and final presentations. This will help to ensure that the project meets or exceeds the client's expectations and meets the highest standards of quality and safety.





2020-Present

Freelance Architect & Master Plumber



One storey residential with mezzanine

The project described is a one-storey residential building with a mezzanine, designed with a modern architectural style and a focus on cost efficiency and sustainability. The owner has placed a strong emphasis on the use of natural ventilation through a combination of various window styles, with jalousies playing a key role. The design also includes a unique approach to sunshade design for the fenestration in the most exposed areas, providing both function and aesthetics. The design incorporates neutral colors for both the interior and exterior, creating a serene and cohesive environment throughout the building. Additionally, a mezzanine is incorporated in the master bedroom for use as a computer area and in the living area as a library, providing extra functionality.

As the design architect, my responsibilities include conducting client meetings, space planning, management studies, programming, and site assessments, in order to understand the client's needs and requirements. Responsible for creating architectural design, drafting, and rendering, ensuring that the design meets the clients' expectations and standards. Additionally, I am responsible for preparing specifications, determining requirements based on budget constraints, and ensuring that the project meets the sustainable standards. It is crucial to maintain clear communication with all stakeholders, ensure that all requirements are met and keep the project well-organized and well-documented throughout the process, including keeping track of design development and final presentations. This will help to ensure that the project meets or exceeds the client's expectations, and meets the highest standards of safety and quality.





Utilizing outdoor wood plastic composite (WPC) in building construction is an environmentally friendly option as it is made of waste wood and recycled plastic material. WPC is a material that is created by combining wood fibers and thermoplastics, making it a sustainable and eco-friendly choice. This material is becoming increasingly popular in the construction industry as it offers a number of advantages over traditional wood.

One of the main advantages of using WPC is its low maintenance requirements. Unlike traditional wood, WPC is resistant to rot, decay, and insect damage, which means it does not require regular staining or sealing to maintain its appearance and structural integrity. This can save homeowners and building managers a significant amount of time and money in the long run.

WPC is also highly durable and can withstand direct sunlight and other harsh weather conditions. This makes it an ideal material for outdoor decking, cladding, and other architectural features. WPC is also resistant to fungi and insect attack, which means it does not attract termites, beetles or other pests that can weaken the structure of a building.

Another advantage of WPC is its versatility. WPC can be produced in a wide variety of colors, styles and textures, making it a great choice for any architectural design. The material can be cut, drilled, and shaped to create a wide variety of different architectural features, such as balustrades, railings, and other decorative elements.

Finally, using WPC in construction is a cost-effective solution. It is a cheaper alternative than traditional wood, and its low maintenance requirements mean that it can save homeowners and building managers money in the long run. The use of WPC in construction is an effective way to reduce waste and promote sustainable building practices.





Two storey residence

The project described is a renovation of a high-end two-storey residence, utilizing modern architecture to create a beautiful and functional space. The focus is on utilizing existing materials that can still be used, in order to be cost-effective and reduce waste. The design incorporates neutral colors on the exterior and interior, creating a serene and cohesive environment throughout the building. The design also incorporates plants on fenestration for passive cooling of the house, creating a healthy living environment while also reducing energy consumption. Furthermore, the owner has placed a strong emphasis on sustainable design, including the use of solar panels as a major source of electrical supply, reducing the building's carbon footprint.

As the design architect, my responsibilities include conducting client meetings, space planning, programming, and site assessments, in order to understand the client's needs and requirements. Responsible for creating architectural design, drafting, and ensuring that the design meets the client's expectations, while also taking into account budget constraints. Additionally, I am responsible for the preparation and revision of architectural layouts for engineering systems such as mechanical, electrical, plumbing and other utility systems, as well as the preparation of as-found plans, to ensure the building is compliant with the current regulations. It is crucial to maintain clear communication with all stakeholders, ensure that all requirements are met and keep the project well-organized and well-documented throughout the process, including keeping track of design development and final presentations.





Two storey residence

The project described is a two-storey residence, designed with a minimalism architectural style and a focus on cost efficiency. The site is located in an area with a moderate slope, and the design incorporates the use of jalousies for windows to fully maximize natural ventilation. The design includes elevating private rooms like bedrooms to provide privacy for the occupants and the use of white color on most of the walls to reflect the sun's heat from the building, which is a sustainable strategy for reducing energy consumption.

As the design architect, my responsibilities include conducting client meetings, space planning, management studies, programming, and site assessments, in order to understand the client's needs and requirements. Responsible for creating architectural design, drafting, and rendering, ensuring that the design meets the client's expectations and standards while also taking into account budget constraints. Additionally, prepare specifications, including determining requirements based on budget constraints, and ensuring that the project meets the sustainable standards. It is crucial to maintain clear communication with all stakeholders, ensure that all requirements are met and keep the project well-organized and well-documented throughout the process, including keeping track of design development and final presentations. This will help to ensure that the project meets or exceeds the client's expectations and adheres to the highest standards of safety and quality.



One storey residence

The project described is a one-storey residence, designed with a Zen architectural style and a focus on cost efficiency. One of the key features of the design is the roof design, which does not use gutters, allowing for natural water flow. The use of jalousies for windows is also incorporated to fully maximize natural ventilation. The design also incorporates the use of light stone sheet for column cladding in outdoor areas, adding a natural aesthetic to the building.

As the design architect and master plumber, my responsibilities include conducting client meetings, space planning, management studies, programming, and site assessments, in order to understand the client's needs and requirements. Responsible for creating architectural design, drafting, and rendering, ensuring that the design meets the client's expectations and standards while also taking into account budget constraints. Additionally, prepare specifications, including determining requirements based on budget constraints, and ensuring that the project meets the sustainable standards. Responsible for drafting and design of plumbing systems, ensuring that they are functional, efficient and meet the code standards. It is crucial to maintain clear communication with all stakeholders, ensure that all requirements are met and keep the project well-organized and well-documented throughout the process, including keeping track of design development and final presentations. This will help to ensure that the project meets or exceeds the client's expectations and adheres to the highest standards of safety and quality.



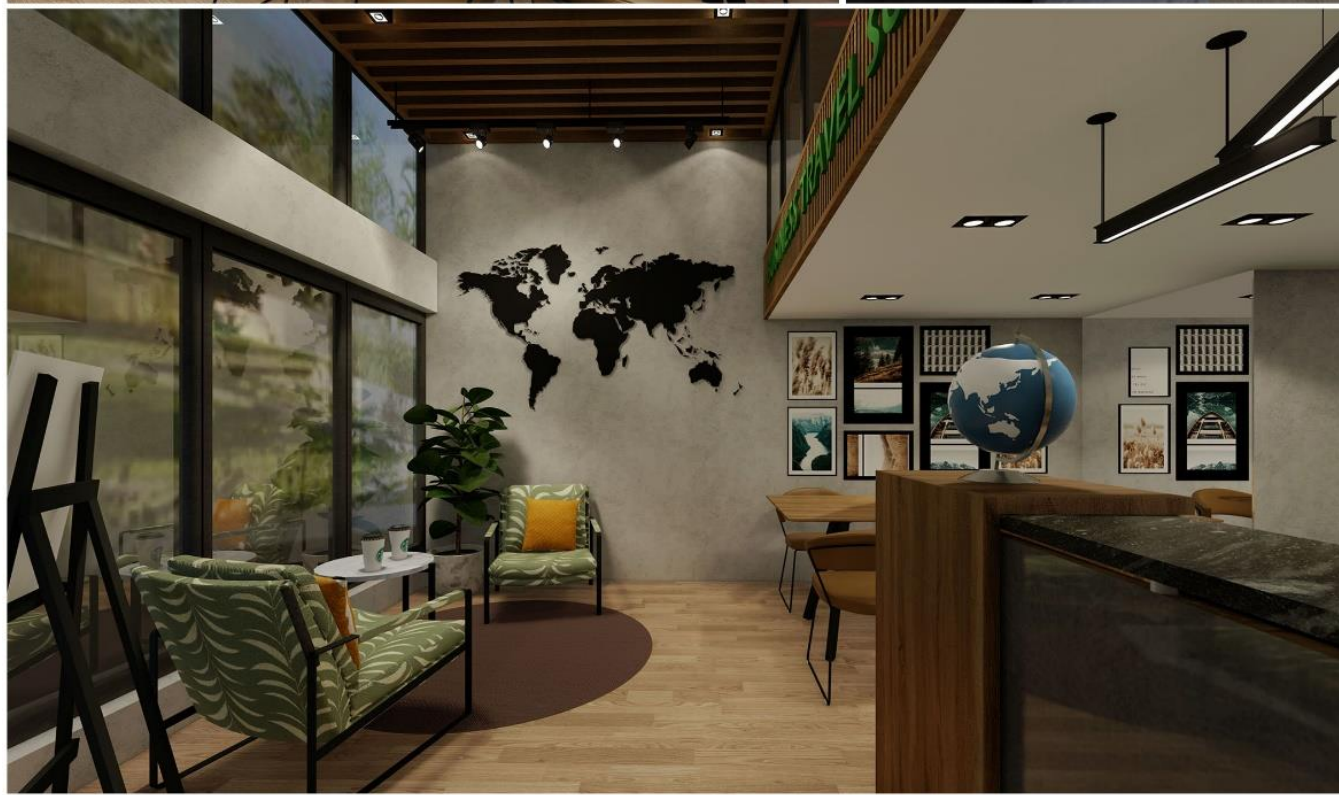

Office interior fit-out

The project described is an office interior fit-out for a travel agency company. The design features an industrial-style architecture, which presents a unique challenge in creating an atypical and visually pleasing. The project also makes use of the natural beauty of materials, incorporating them into the design of furniture, wall cladding, and systems. The walls will be painted to emulate a concrete finish. As the design architect, my responsibilities include conducting client meetings, space planning, management studies, programming, and site assessments, in order to understand the client's needs and requirements. Responsible for creating architectural design, drafting, and rendering, ensuring that the design meets the client's expectations and standards while also taking into account budget constraints. Additionally, prepare specifications, including determining requirements based on budget constraints, and ensuring that the project meets the sustainable standards. It is crucial to maintain clear communication with all stakeholders, ensure that all requirements are met and keep the project well-organized and well-documented throughout the process, including keeping track of design development and final presentations. This will help to ensure that the project meets or exceeds the client's expectations and adheres to the highest standards of safety and quality.



One storey residence

The project described is a one-storey residence, designed with a Zen architectural style and a focus on cost efficiency. One of the key features of the design is the roof design, which does not use gutters, allowing for natural water flow. The use of jalousies for windows is also incorporated to fully maximize natural ventilation. The design also incorporates the use of light stone sheet for column cladding in outdoor areas, adding a natural aesthetic to the building.

As the design architect and master plumber, my responsibilities include conducting client meetings, space planning, management studies, programming, and site assessments, in order to understand the client's needs and requirements. Responsible for creating architectural design, drafting, and rendering, ensuring that the design meets the client's expectations and standards while also taking into account budget constraints. Additionally, prepare specifications, including determining requirements based on budget constraints, and ensuring that the project meets the sustainable standards.

Responsible for drafting and design of plumbing systems, ensuring that they are functional, efficient and meet the code standards. It is crucial to maintain clear communication with all stakeholders, ensure that all requirements are met and keep the project well-organized and well-documented throughout the process, including keeping track of design development and final presentations. This will help to ensure that the project meets or exceeds the client's expectations and adheres to the highest standards of safety and quality.





2023-Present
Architectural Designer

